

BAIRRO MARECHAL CARMONA

Proposta de Desenho Urbano

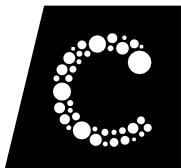





Área de
Intervenção

57 292.41 m²



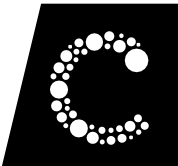

Área de
arruamentos,
estacionamento e
espaços verdes
29 724.41 m²

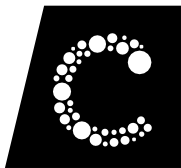
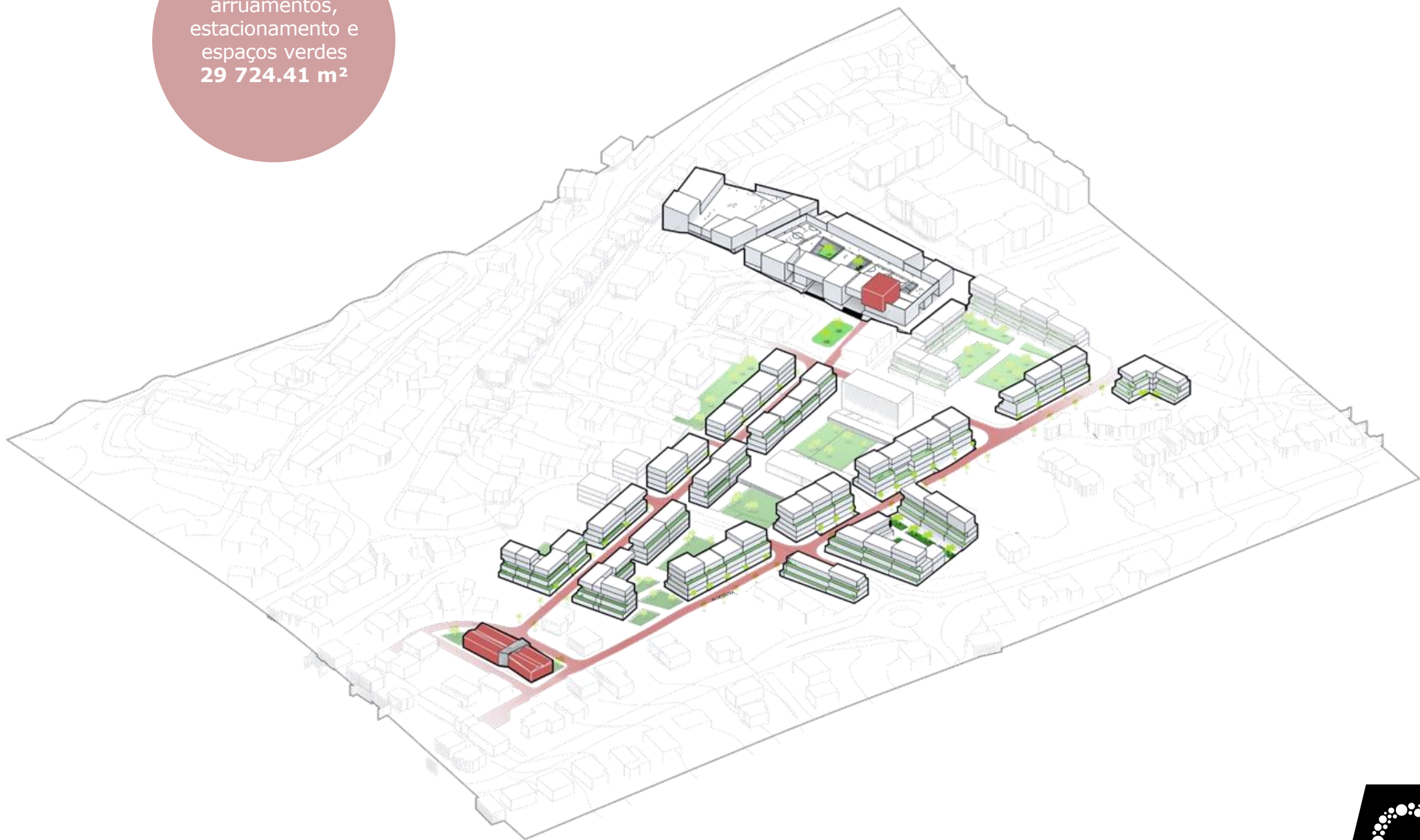

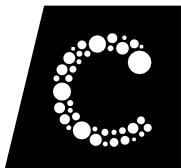

Superfície de
pavimento destinada
a habitação (486
fogos)
45 657 m²



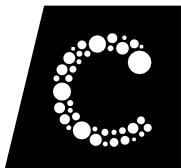

Superfície de
pavimento destinada
a equipamentos
11 077m²



